

## Relay Socket

KML2-B

### Characteristics

- Ambient temperature : -40°C to 70°C
- Rated voltage : 250VAC
- Rated current : 10A
- Dielectric strength(Min.) : 1500VAC (between input and output)
- Steel retainer : Available
- Type: PCB terminal, PCB mounting
- Applicable relay type : KML, EKML series (1, 2 poles)

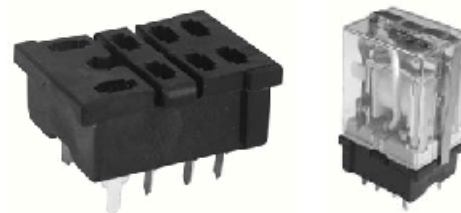

CS US (File No.:E122258)

### Outline Dimensions

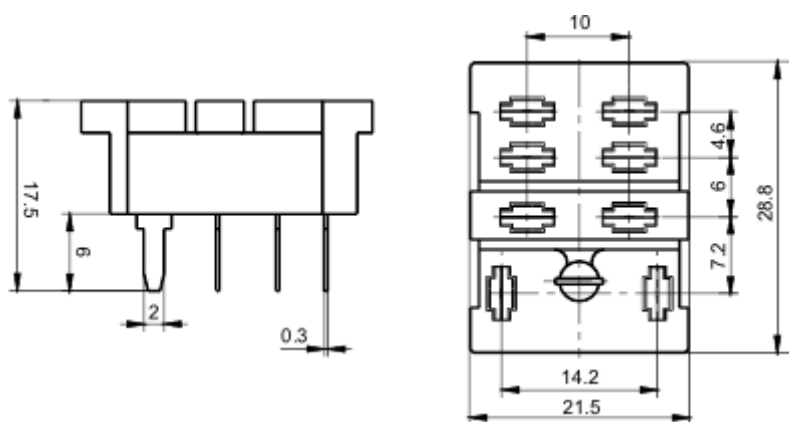

(Top View)

### PCB Layout

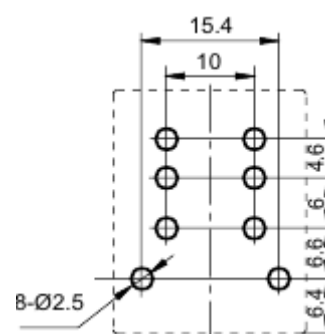

### Retainer Dimensions (KM-R1)



## Relay Socket

KML2-C

### Characteristics

- Ambient temperature : -40°C to 70°C
- Rated voltage : 250VAC
- Rated current : 10A
- Dielectric strength(Min.) : 2000VAC (between input and output)
- Steel retainer : Available
- Screw torque : 1.0Nm
- Wire strip length: 7mm
- Max. wire range: 2 x 2.5mm<sup>2</sup>
- Type: DIN rail or Screw mounting, Screw terminal, Without finger protection device
- Applicable relay type : KML, EKML series (1, 2 poles)



CS US (File No.:E122258)

Outline Dimensions

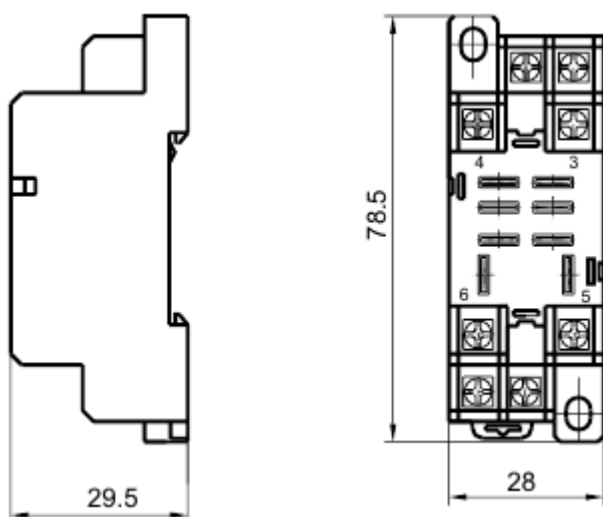

(Top View)

PCB Layout

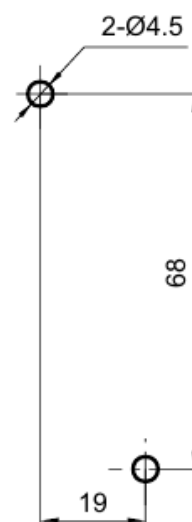

Retainer Dimensions (KM-R2)

Wiring Diagram

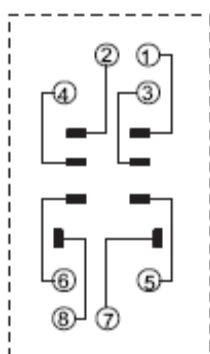

(Top View)

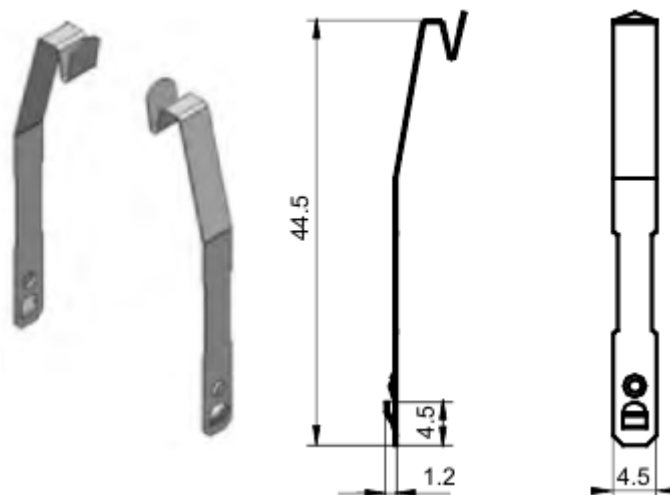

## Relay Socket

KML□-C

### Characteristics

- Ambient temperature: -40℃ to 75℃
- Rated voltage: 250VAC
- Rated current: 10A
- Dielectric strength(Min.): 2000VAC (between input and output)
- Socket material: KML3 - Flame retardance PA46-S250F6(V0)  
KML4 - Flame retardance PA66+GF(V1/V0)
- Contact spring material: QSn6.5-0.1
- Hold down spring(on request): Plastic
- Applicable relay type : EKML series (3, 4 poles)



(File No.:E134581)

### Outline Dimensions

### Wiring Diagram



KML3-C

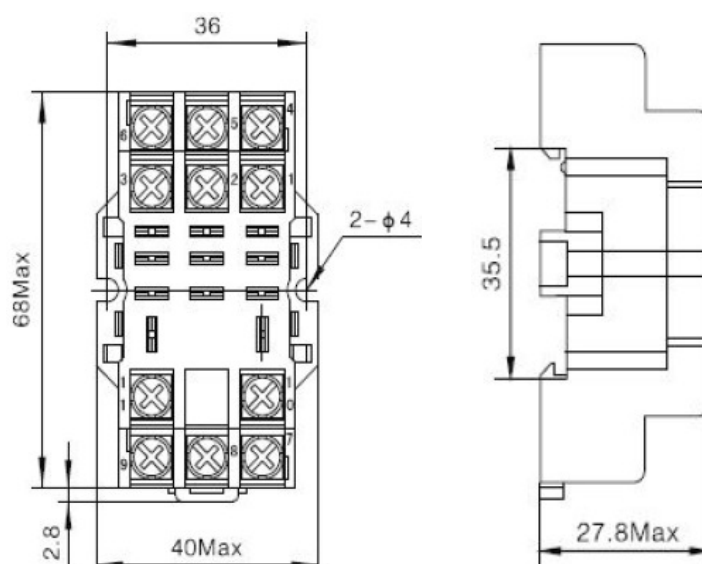

KML4-C

