

Relay Socket

KMK□-A

Characteristics

- Ambient temperature : -40°C to 70°C
- Rated voltage : 250VAC
- Rated current : 10A
- Dielectric strength(Min.) : 2000VAC (between input and output)
- Terminal torque : 1.0Nm
- Wire strip length: 7mm
- Max. wire size: 2 x 1.5mm²
- Applicable relay type : KMK2 and KMK3 series (2 & 3poles)

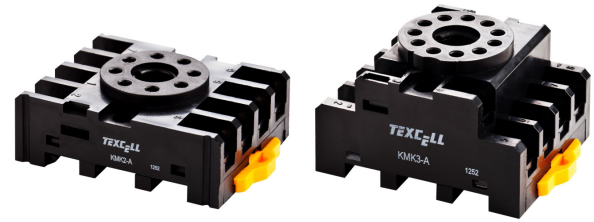

KMK2-A

Outline Dimensions

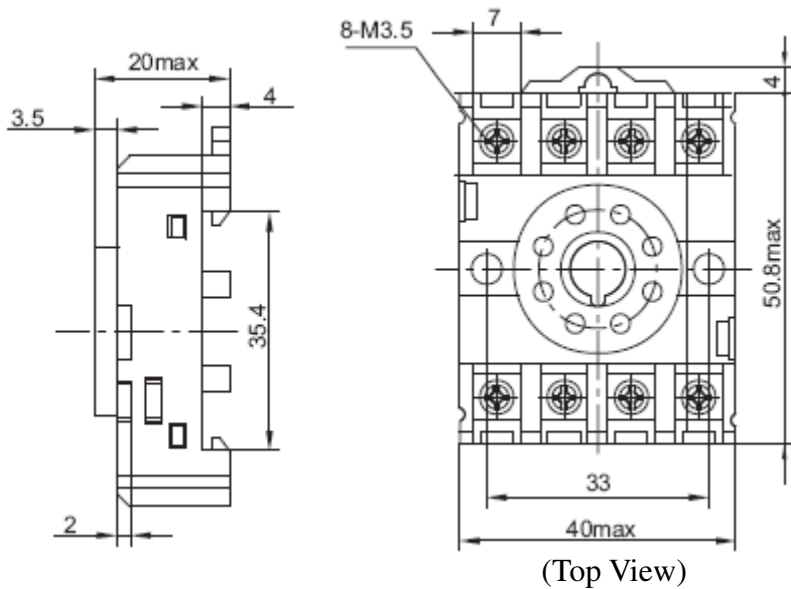

Wiring Diagram

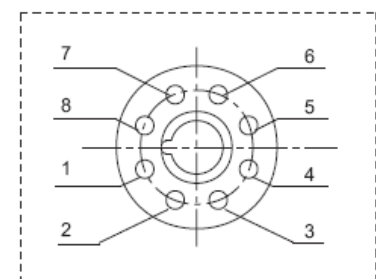

(Top View)

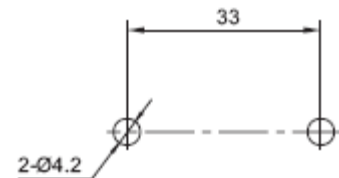

PCB Layout

KMK3-A

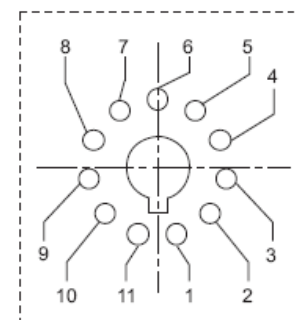
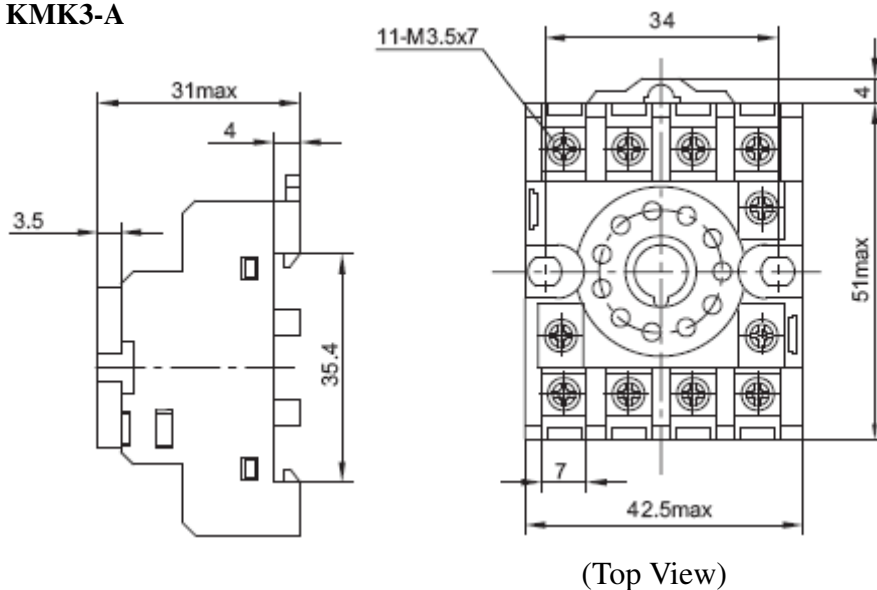

(Top View)

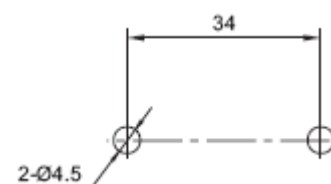

Relay Socket

KMK□-B

Characteristics

- Ambient temperature : -40°C to 70°C
- Rated voltage : 250VAC
- Rated current : 10A
- Dielectric strength(Min.) : 2000VAC (between input and output)
- Terminal torque : 1.0Nm
- Wire strip length: 7mm
- Max. wire size: 2 x 1.5mm²
- Applicable relay type : KMK2 and KMK3 series (2 & 3poles)



KMK2-B

Outline Dimensions

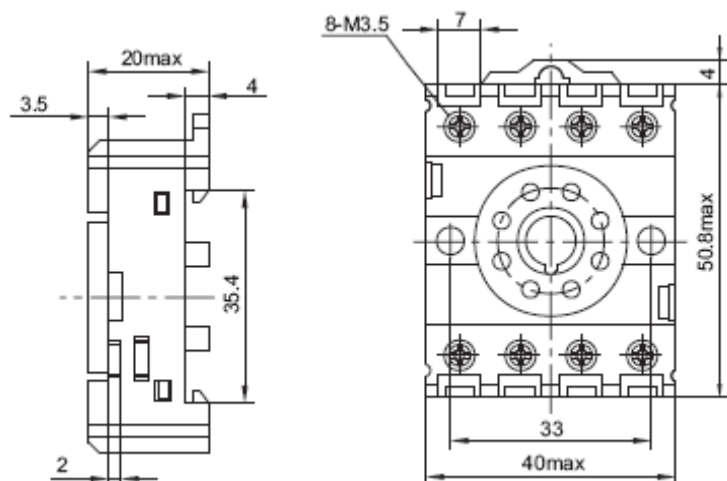

(Top View)

Wiring Diagram

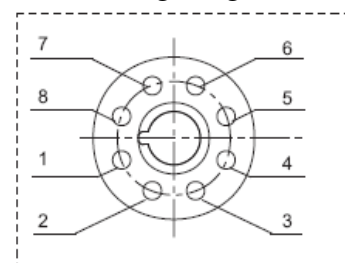

(Top View)

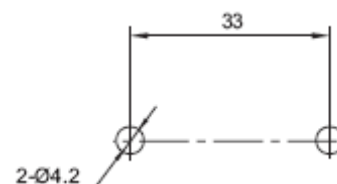

PCB Layout

KMK3-B

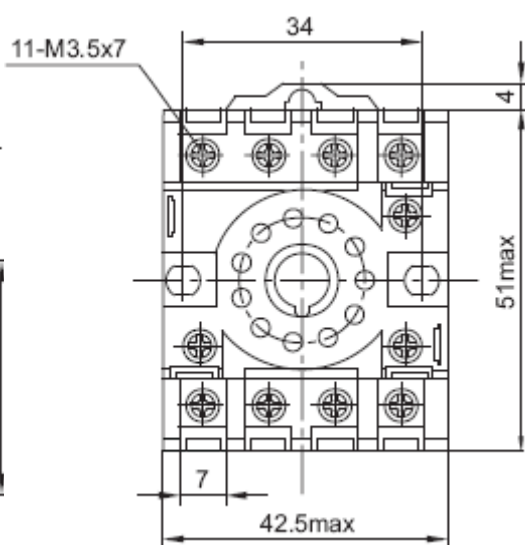

(Top View)

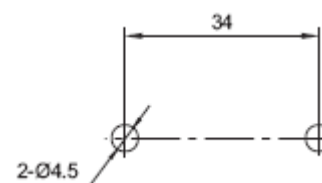
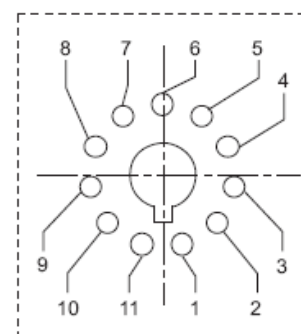

Relay Socket

KMK□-C

Characteristics

- Ambient temperature : -40°C to 70°C
- Rated voltage : 250VAC
- Rated current : 10A
- Dielectric strength(Min.) : 2000VAC (between input and output)
- Steel retainer : Available
- Terminal torque : 0.6Nm
- Wire strip length: 7mm
- Max. wire range: 1 x 4 / 2 x 2.5mm²
- Applicable relay type : KMK2 and KMK3 series (2 & 3poles)



KMK2-C

Outline Dimensions

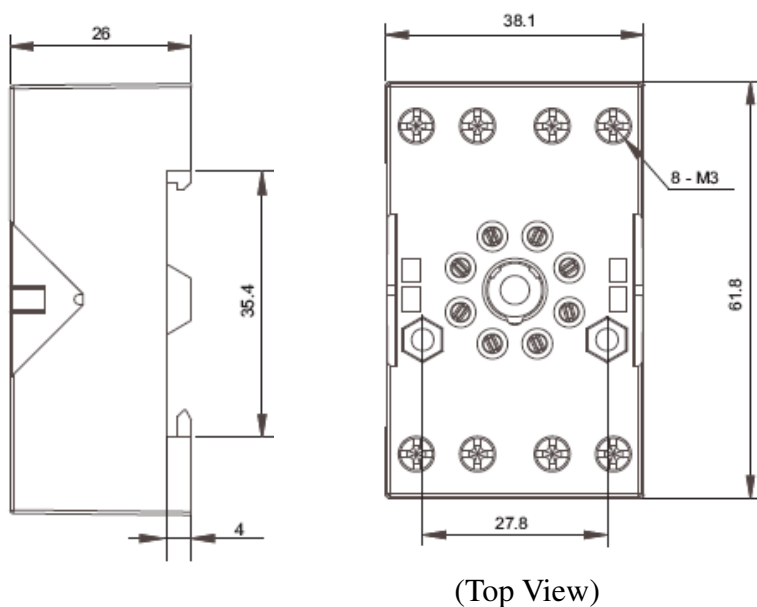

Wiring Diagram

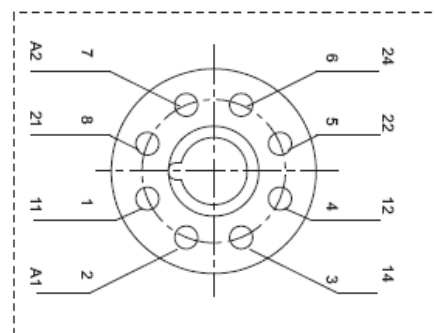

(Top View)

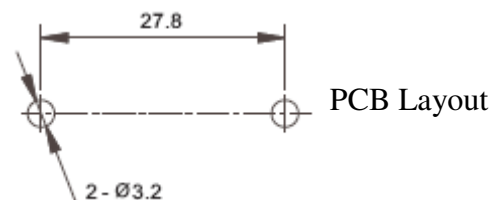

KMK3-C

